



# DIGIWAY GATE MOTOR

## Domestic Slider SL300DC



### Specifications

SL300DC domestic sliding gate motor

24V DC motor with battery backup

Encode technology, no limit switch

Two remote control, 2x4.5Ah batteries

Removable transformer, 4M rack (option)

Aluminum cabinet

Gate weight up to 300KG

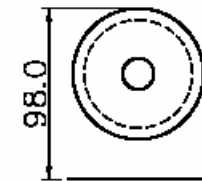
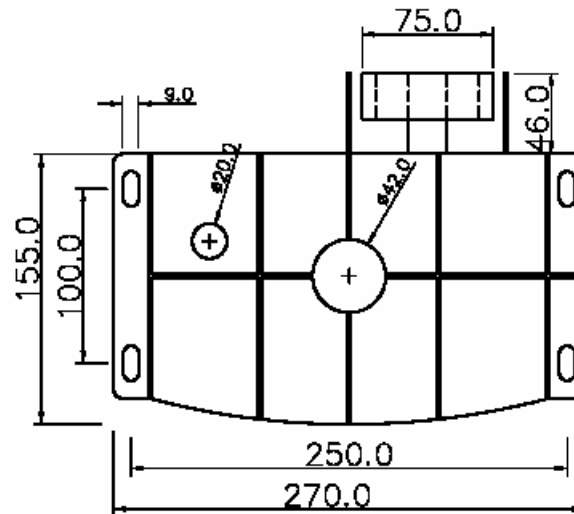

Guide Only  
Exactly See  
Motor

**Digiway** The better way

